

Person Submitting Cross Section \_\_\_\_\_

Job Address \_\_\_\_\_

Date: \_\_\_\_\_

Engineered Truss System  Yes  No

**Headers shall be labeled on the floor plan or roof framing plan**

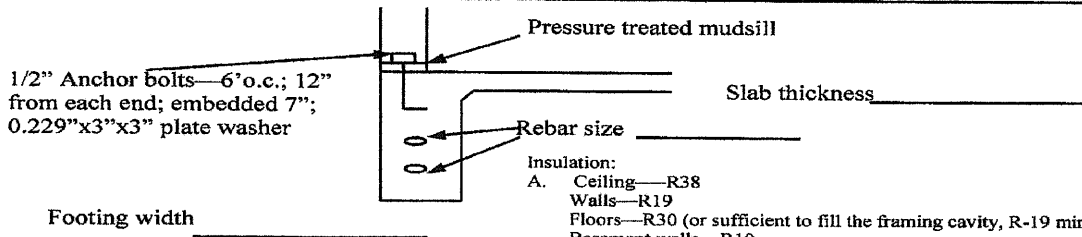
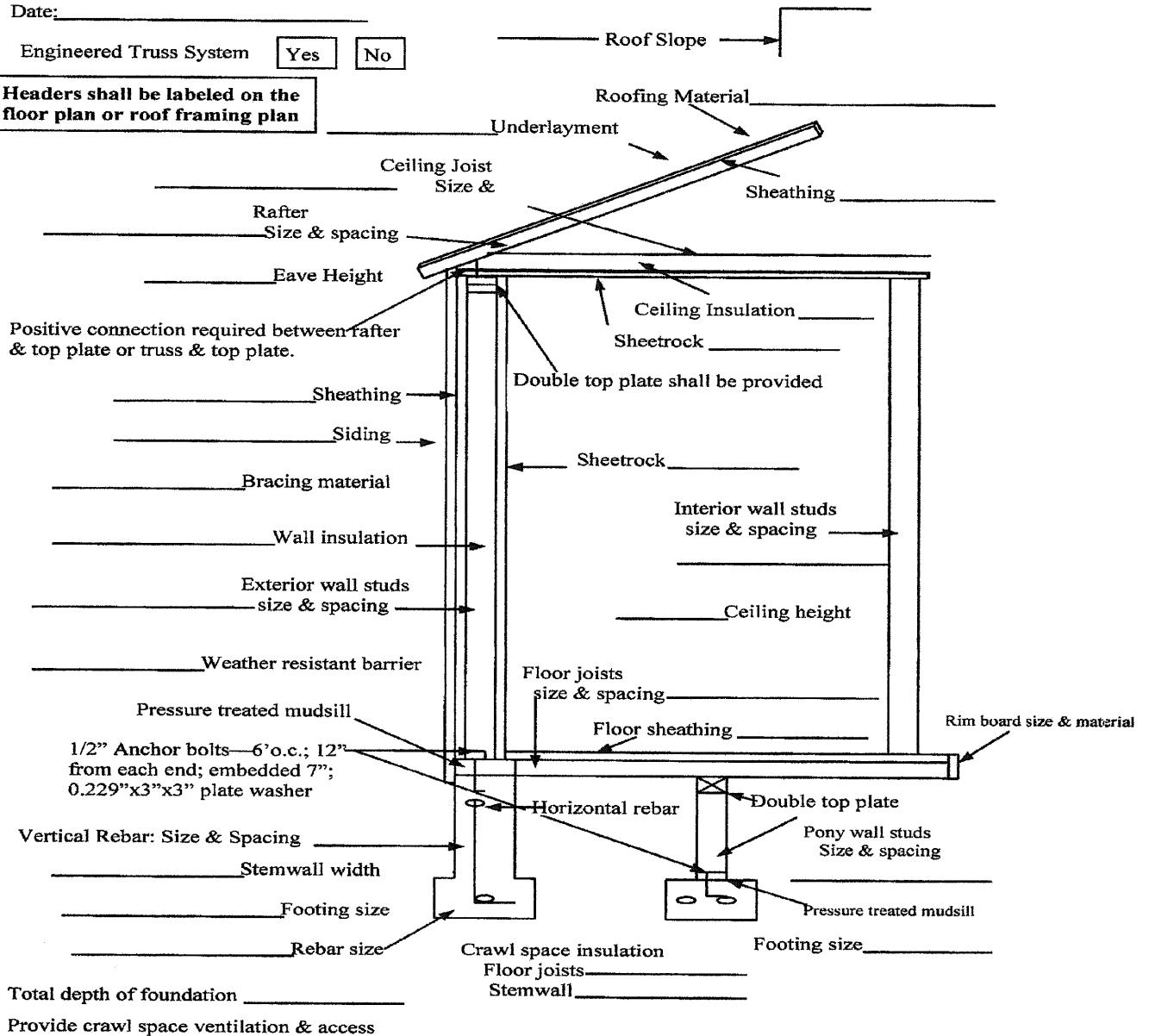

Total depth of foundation \_\_\_\_\_

Revised 01-09

- Insulation:
- A. Ceiling—R38
  - Walls—R19
  - Floors—R30 (or sufficient to fill the framing cavity, R-19 min.)
  - Basement walls—R10
  - Crawl Space walls—R10
  - B. Stemwall insulation—Do not install under floor vents. See other specific requirements
  - C. Floor insulation—install under floor vents. Wrap all ducts and water lines below the insulation.
  - D. Slab insulation—R-10 for 24". Insulation shall extend downward from the top of the slab on the outside or inside of the foundation wall. Insulation located below grade shall be extended by 2' in any combination of vertical insulation, insulation extending under the slab or insulation extending out from the building.